

WIGSTON 1 SUITE FLOOR PLAN

(W – Window; FD – Fire Door; LCD – TV; P – Pillar)

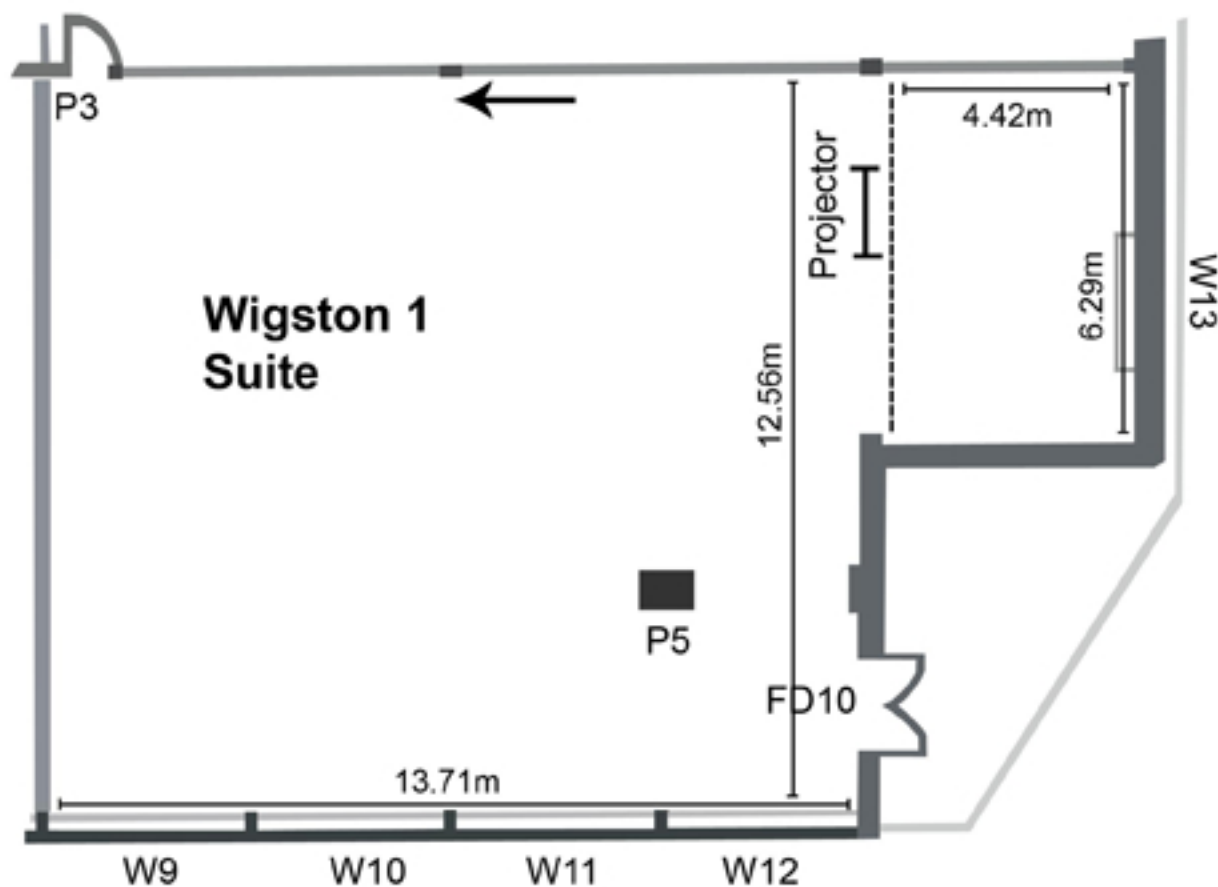

Wigston 1 Suites: 13.71m x 12.56m and
6.29m x 4.42m

Ceiling Height: Between 2.30m – 3.30m

Window 9: 6.05m x 3.08m

Window 10: 6.05m x 3.08m

Window 11: 6.05m x 3.08m

Window 12: 6.05m x 3.08m

Window 13: 2.38m x 79cm

Fire Door 10: 1.96m x 1.65m

Sockets: 10 Double (20 Total)